

## Permanent Magnet Synchronous AC Gear Motor- Model 550 HT

High Load permanent magnet motor suitable for demanding applications. It is electrically reversible and available in output speeds from .25RPM up to 120 RPM.

### Model 550HT Features

- Tough Extruded Aluminum gear housing
- Die cast end covers
- Oil impregnated output shaft bearings
- All metal gearing
- First stage gears are helical for lower noise
- UL/CUL & CSA Recognized
- Leads- As required

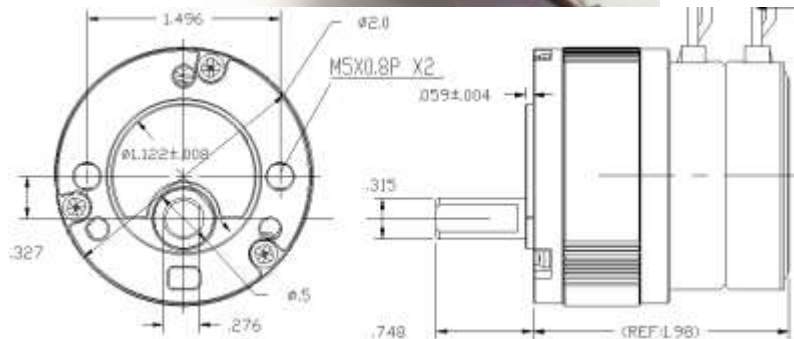

### Specifications

- Continuous torque rating from 69 oz. in (5 Kg-Cm) up to 416 oz. in. (30 Kg-Cm)-ratio dependent
- Available with either .236 in.(6mm) or .315 in. (8mm) diameter shaft with flat
- Available in 12V, 24V, 115V & 230 V
- Designed for 50Hz, 60Hz or 60/50Hz applications
- Input 5 Watts
- Rotor Speed 720 RPM